

FRONT VIEW

| REVISIONS | | | | |
|-----------|------|-------------|------|---------|
| REV. | ZONE | DESCRIPTION | DATE | INITIAL |

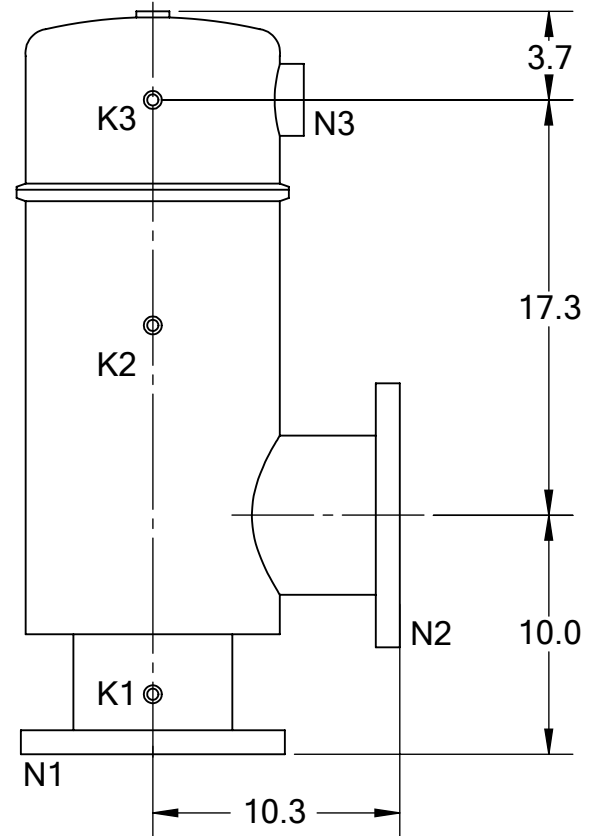

SIDE VIEW

TECHNICAL DATA

| | |
|---------------------|---------------------------------------|
| FLOW RATE | MAX. 600 GPM (136 m ³ /hr) |
| SCREEN SIZE | ___ MICRON |
| SCREEN AREA | 3.0 SQ. FEET |
| MAXIMUM TEMPERATURE | MAX. 200 °F |
| MAXIMUM PRESSURE | MAX. 150 PSI |
| EMPTY WEIGHT | ~120 LBS. |
| FULL WEIGHT | ~220 LBS. |

| NOZZLE | CONNECTION | TYPE | SIZE | RATING |
|--------|---------------------|----------|-------------|---------------------|
| K1 | HIGH PRESSURE CONN. | THREADED | 1/4" NPT(2) | CLASS #150 F.F.S.O. |
| K2 | LOW PRESSURE CONN. | THREADED | 1/4" NPT | |
| K3 | HYDRAULIC CONN. | THREADED | 1/4" NPT | CLASS #150 F.F.S.O. |
| N1 | INLET | FLANGED | 6" ASA | |
| N2 | OUTLET | FLANGED | 6" ASA | |
| N3 | FLUSH OUTLET | THREADED | 2" NPT | |

TOLERANCES (UNLESS OTHERWISE SPECIFIED)

FRAC. ±1/16
 .X ±.1
 .XX ±.05
 .XXX ±.010

ANGLE ±1°

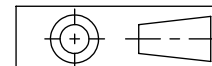

MATERIAL: SST

DRAWN BY: S. PERKINSON

DATE: 11/11/11

SCALE: 1:9 **SHEET:** 1 OF 1

TEKLEEN
 Automatic Filters Inc.
 2672 S. LA CIENEGA BLVD.
 LOS ANGELES, CA 90034
 MAIN: (310) 839-2828
 FAX: (310) 839-6878

TITLE: MTF6 FILTER, CUT DRAWING

| | |
|-----------------------|------------|
| DRAWING NUMBER | REV |
| MTF-6-CUT-01 | N/A |