

FRONT VIEW

REVISIONS				
REV.	ZONE	DESCRIPTION	DATE	INITIAL
1	1B, 2B, 2C	CHANGED "WORKING" TO "DESIGN" & TEMPERATURE FROM 200°F TO 160°F IN TECHNICAL DATA TABLE, CHANGED INLET HEIGHT FROM 2.5" TO 3".	01/29/14	S.P.

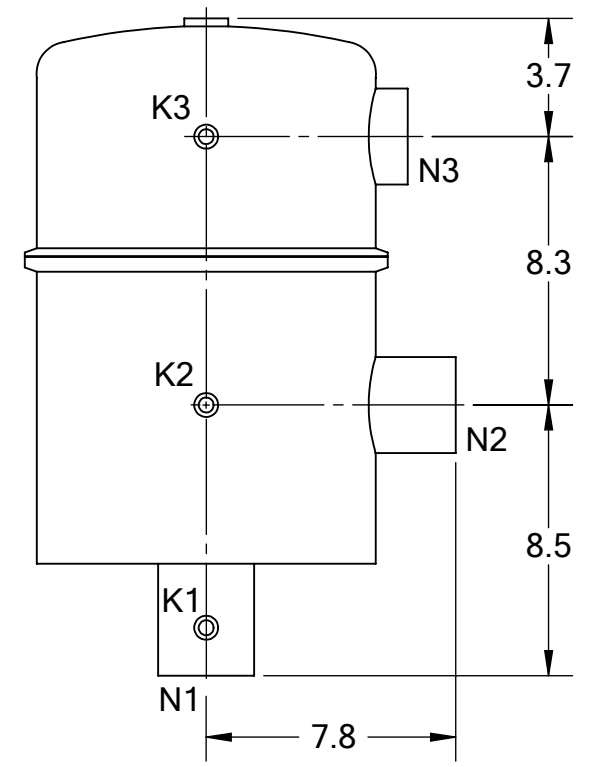

SIDE VIEW

TECHNICAL DATA

FLOW RATE	MAX. 200 GPM (45 m ³ /hr)
SCREEN SIZE	___ MICRON
SCREEN AREA	1.5 SQ. FEET
DESIGN TEMPERATURE	160 °F
DESIGN PRESSURE	150 PSI
EMPTY WEIGHT	~70 LBS.
FULL WEIGHT	~140 LBS.

NOZZLE	CONNECTION	TYPE	SIZE	RATING
K1	HIGH PRESSURE CONN.	THREADED	1/4" NPT(2)	
K2	LOW PRESSURE CONN.	THREADED	1/4" NPT	
K3	HYDRAULIC CONN.	THREADED	1/4" NPT	
N1	INLET	THREADED	2" NPT	
N2	OUTLET	THREADED	2" NPT	
N3	FLUSH OUTLET	THREADED	2" NPT	

TOLERANCES (UNLESS OTHERWISE SPECIFIED)

FRAC. ±1/16	ANGLE ±1°
.X ±.1	
.XX ±.05	
.XXX ±.010	

MATERIAL: SST

DRAWN BY: S. PERKINSON

DATE: 11/11/11

SCALE: 1:6 **SHEET:** 1 OF 1

TEKLEEN®
Automatic Filters Inc.
 2672 S. LA CIENEGA BLVD.
 LOS ANGELES, CA 90034
 MAIN: (310) 839-2828
 FAX: (310) 839-6878

TITLE:
 MTF2-L FILTER,
 CUT DRAWING

DRAWING NUMBER	REV
MTF-2L-CUT-01	1