

REVISIONS				
REV.	ZONE	DESCRIPTION	DATE	INITIAL
1	ALL	INCREASED CENTER-TO-OUTLET PIPE LENGTH TO 15.7" & REDUCED OUTLET CENTER HEIGHT TO 23.6".	06/08/11	S.P.
2	3B	CHANGED MAX. FLOW RATE FROM 1,700 TO 2,400 GPM.	06/10/11	S.P.

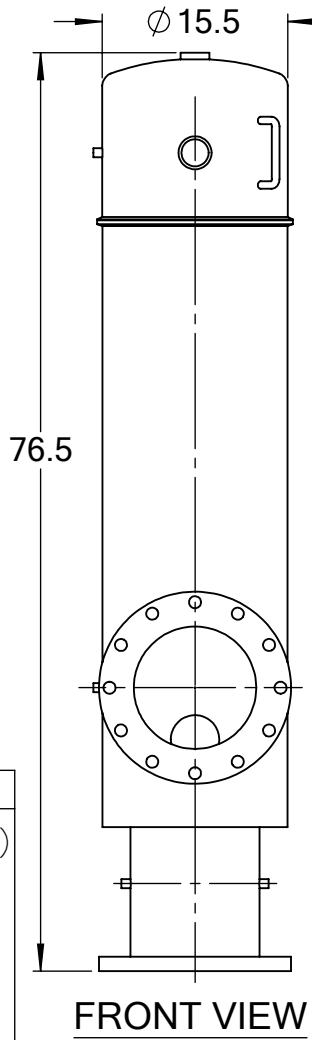

FRONT VIEW

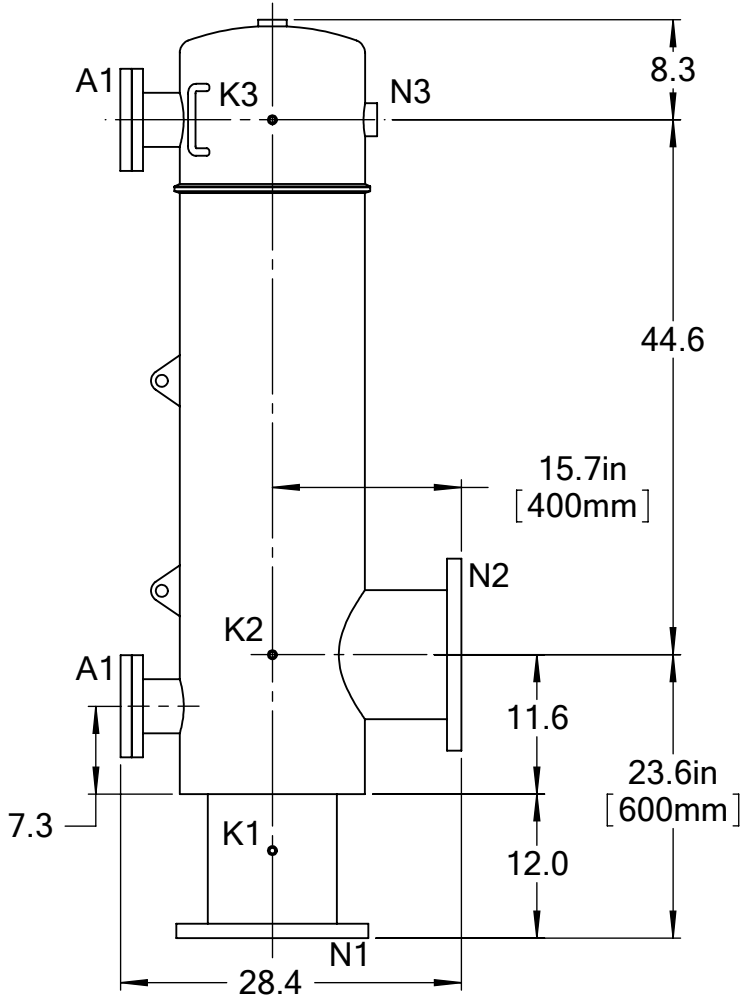

SIDE VIEW

TECHNICAL DATA

FLOW RATE	MAX. 2,400 GPM (545 m ³ /hr)
SCREEN SIZE	_____ MICRON
SCREEN AREA	11.0 SQ. FEET
WORKING TEMPERATURE	MAX. 200 °F
WORKING PRESSURE	MAX. 150 PSI
EMPTY WEIGHT	~500 LBS.
FULL WEIGHT	~1,000 LBS.

NOZZLE	CONNECTION	TYPE	SIZE	RATING
A1	SERVICE PORT	FLANGED	3.5" ASA	CL. #150 F.F. w/ Blind
K1	HIGH PRESSURE CONN.	THREADED	1/4" NPT(2)	
K2	LOW PRESSURE CONN.	THREADED	1/4" NPT(2)	
K3	HYDRAULIC CONN.	THREADED	1/4" NPT(2)	CLASS #150 F.F.S.O. CLASS #150 F.F.S.O.
N1	INLET	FLANGED	10" ASA	
N2	OUTLET	FLANGED	10" ASA	
N3	FLUSH OUTLET	THREADED	2" NPT	

TOLERANCES (UNLESS OTHERWISE SPECIFIED)

FRAC. ±1/16	ANGLE ±1°
.X ±.1	
.XX ±.05	
.XXX ±.010	

MATERIAL: SST
DRAWN BY: S. PERKINSON
DATE: 05/26/11
SCALE: 1:16
SHEET: 1 OF 1

TEKLEEN
Automatic Filters Inc.
2672 S. LA CIENEGA BLVD.
LOS ANGELES, CA 90034
MAIN: (310) 839-2828
FAX: (310) 839-6878

TITLE: MTF10-L FILTER, CUT DRAWING	
DRAWING NUMBER	REV
MTF-10L-CUT-01	2