

REVISIONS				
ZONE	REV	DESCRIPTION	DATE	APPROVED

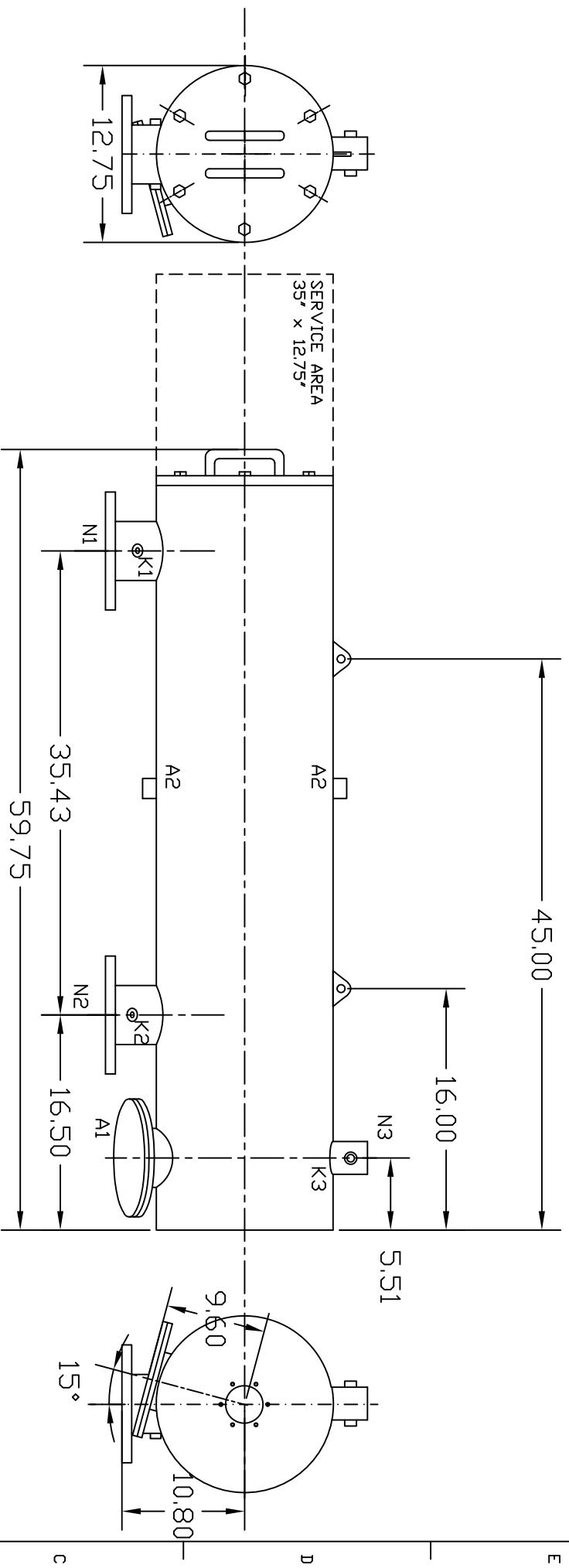

**TECHNICAL DATA**

Flow Rate Max. 600 GPM (150 cu m/hr.)  
 Screen Size --- Micron  
 Screen Area 5.0 Sq.Ft.  
 Working Temp. 200 deg. F  
 Working Pressure 150 PSI  
 Empty Weight 230 lbs.  
 Full Weight 419 lbs.

NOZZLE	CONNECTION	TYPE OF CONNECTION	SIZE	RATING
A1	Service Port	Flanged	3.5" ASA	150 lbs. F.F. w/Blind
A2	Pressure Release	Threaded	1" NPT(2)	
K1	Hi. Press. Conn.	Threaded	1/4" NPT(2)	
K2	Low Press. Conn.	Threaded	1/4" NPT(2)	
K3	Hydraulic Conn.	Threaded	1/4" NPT(2)	
N1	Inlet	Flanged	4" ASA	150 lbs. F.F.
N2	Dutlet	Flanged	4" ASA	150 lbs. F.F.
N3	Flushoutlet	Threaded	2" NPT	

UNLESS OTHERWISE SPECIFIED  
 DIMENSIONS ARE IN INCHES  
 TOLERANCES  
 DECIMALS .XX ± .05  
 .XXX ± .01  
 ANGULAR ± 0.5 DEG.

DRAWN	DATE
Daniel Stenberg	6-8-05
CHECKED	
DESIGN	

AUTOMATIC FILTERS, INC. 2672 S. LA CIENEGA BLVD. LDS ANGELES, CA 90034 (310) 839-2828 FAX (310) 839-6878	
TITLE	
ABW4-LP	
SIZE	DWG. NO.
A	AKW4-1P
NTS	
SHEET	DF
	2